

TEMPORARY ACCESS FOR CONSTRUCTION

PERMANENT ACCESS

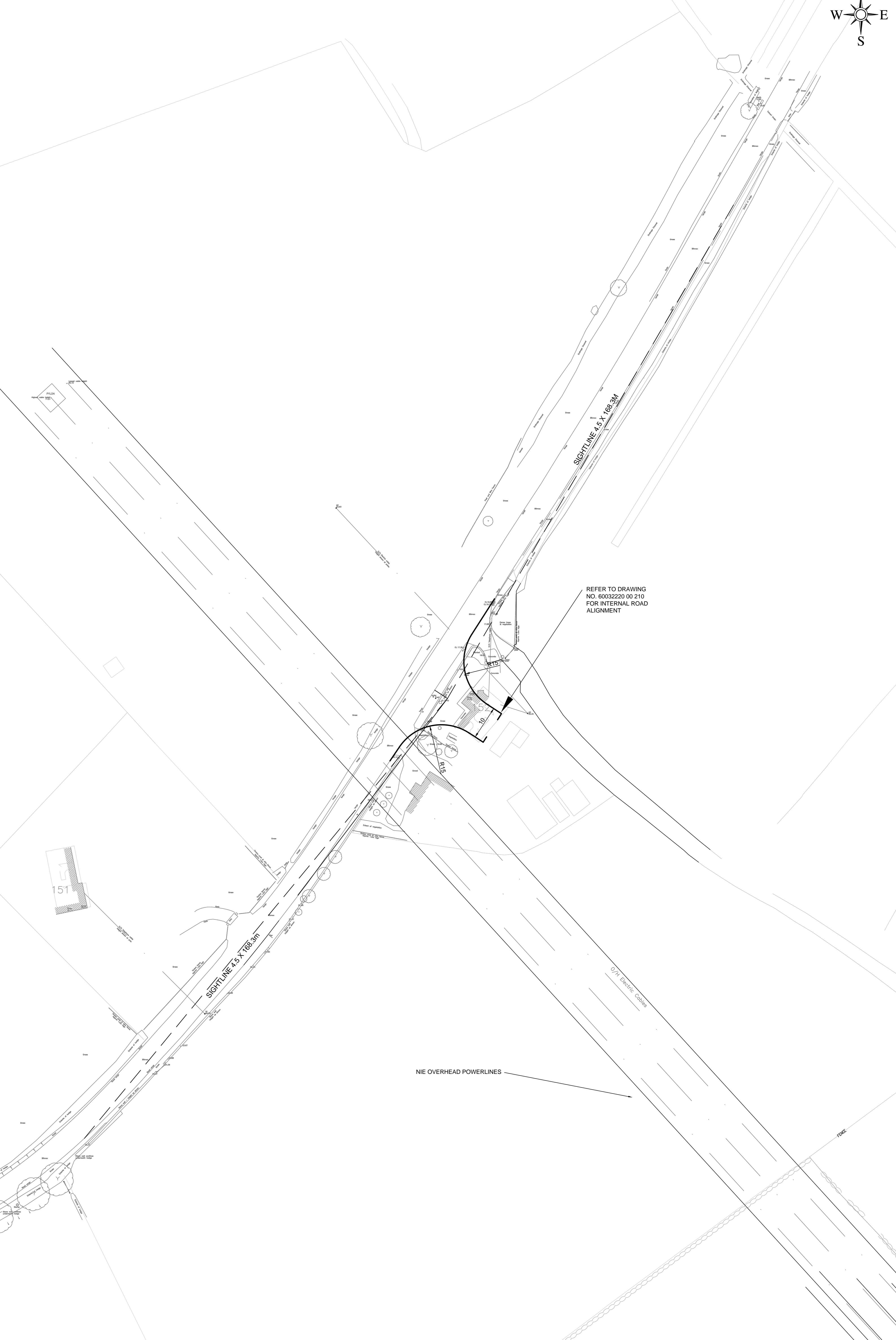
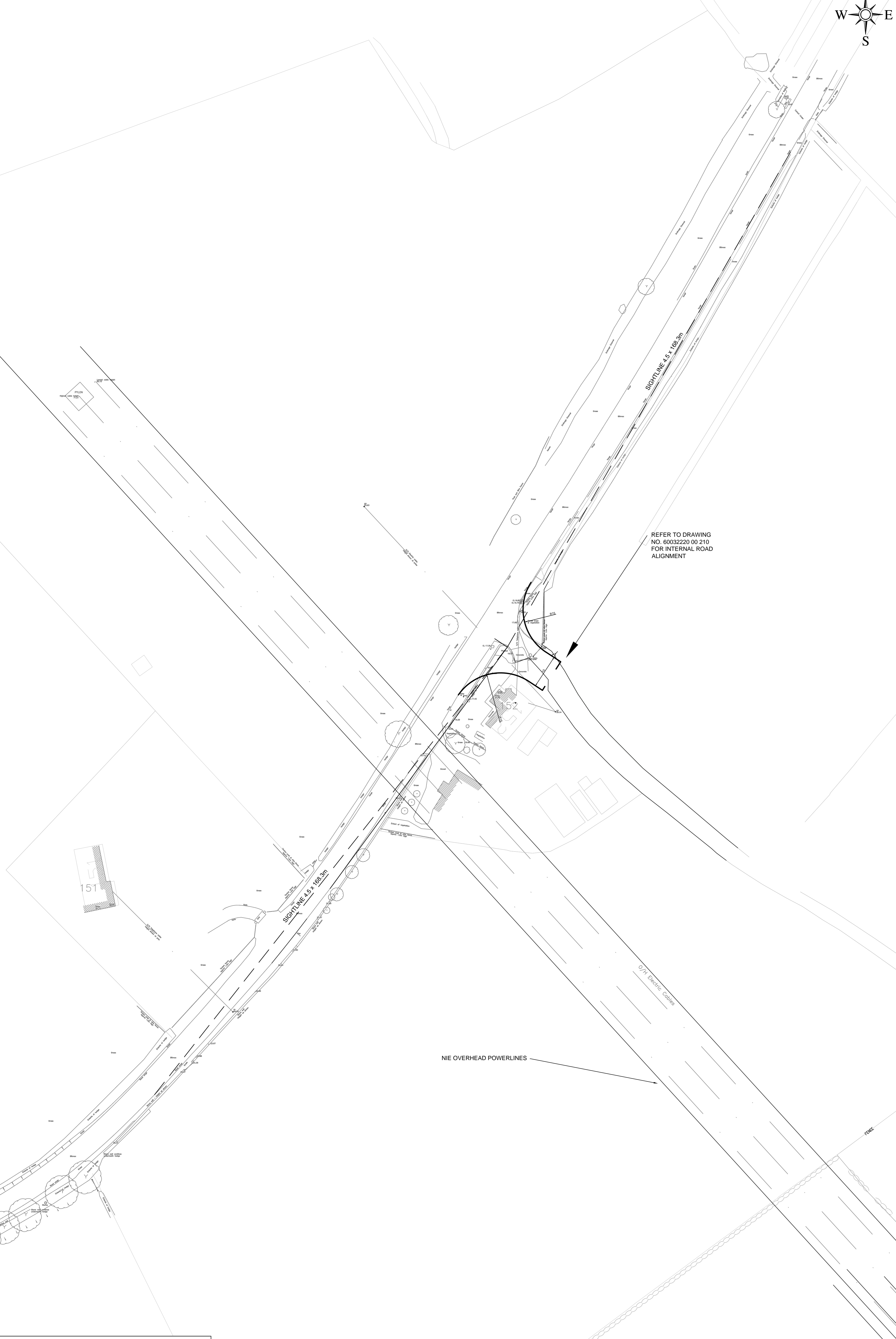

- NOTES**
1. DESIGN BASED UPON TOPOGRAPHICAL SURVEY SUPPLIED BY OTHERS.
 2. ALL DIMENSIONS IN METRES UNLESS OTHERWISE STATED.
 3. ALL NEW ROAD MARKINGS TO BE APPROVED BY DRD ROADS SERVICE PRIOR TO APPLICATION.
 4. EXISTING ROADMARKINGS THAT ARE SUPERSEDED BY THE NEW ROADMARKINGS SHALL BE REMOVED.
 5. ALL NEW MARKINGS ARE TO BE LAID IN THERMOPLASTIC SCREED WITH APPLIED SOLID GLASS BEADS.
 6. ALL DIAGRAM NUMBERS REFER TO TRAFFIC SIGNS REGULATIONS (NORTHERN IRELAND) 1997.
 7. IT IS THE RESPONSIBILITY OF THE CONTRACTOR TO NOTIFY THE ENGINEER OF ANY DISCREPANCIES ON THE DRAWING PRIOR TO CONSTRUCTION.

Rev	Drawn	Checked	Issue	Drawn	Issue
PLANNING					
Project: TYRONE TO CAVAN INTERCONNECTOR					
Title: PROPOSED ACCESS DETAILS					
Design:	RPW	CAD:	RPW		
Check:	SJT	Appr:	TJR		
Date:	APRIL 2013	Scale:	1:500		
<small>8th Floor The Clarence West Building 2 Clarence Street West BELFAST BT2 7JF</small>					
<small>Tel: +44 (0) 28 9060 7200 Fax: +44 (0) 28 9060 7399 www.aecom.com</small>					
No. 60032220 00 211					Rev. C
cm					